

KLAR GLASS BALUSTRADE



KLAR

STUDIO | WINDOWS+DOORS

KLAR glass balustrades are strong and durable. They last for many years, and require very little to no maintenance. The glass balustrade gives visual appeal at the same time providing safety. Glass is an excellent way to ensure that the views of your landscape and surroundings are unobstructed. Many thicknesses of glass are available to fulfill your needs and specifications.



POSSIBLE CONFIGURATIONS

ASSEMBLY OVER SLAB



ASSEMBLY ON SLAB EDGE



POSSIBLE CONFIGURATIONS

ASSEMBLY OVER SLAB

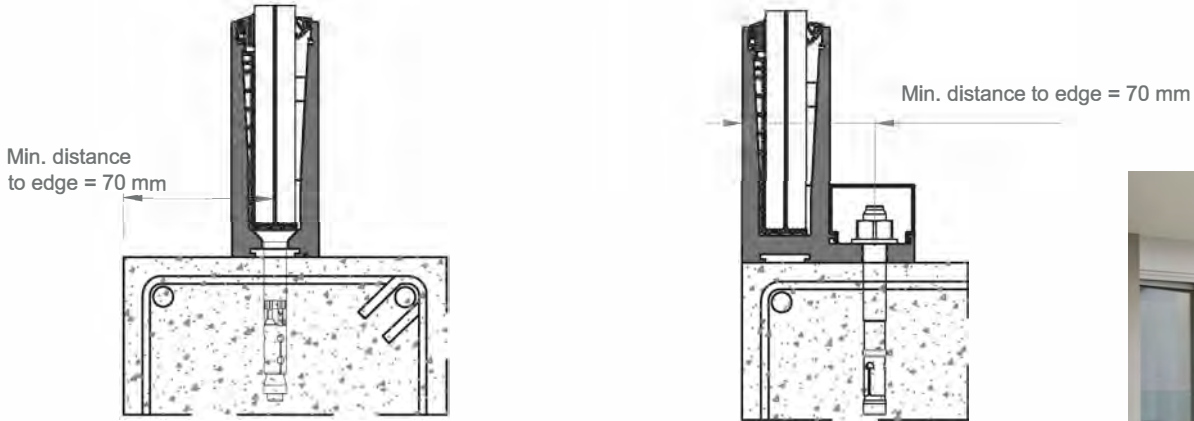

ASSEMBLY OVER SLAB WITH DRAINAGE PROFILE

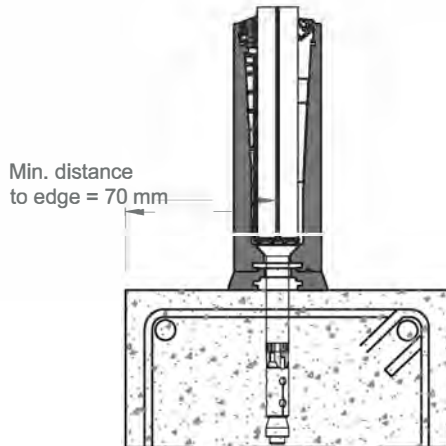

POSSIBLE CONFIGURATIONS

ASSEMBLY ON SLAB EDGE

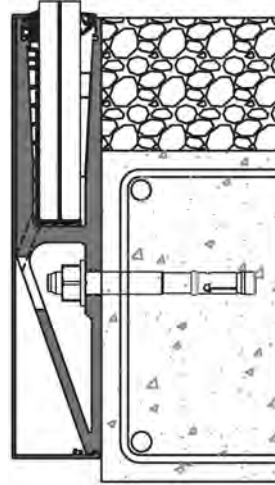
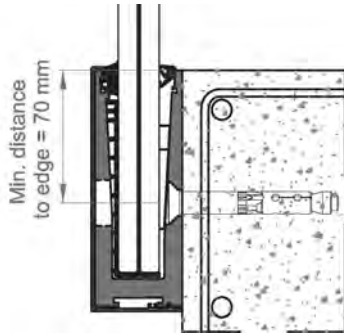

ASSEMBLY ON SLAB EDGE WITH DRAINAGE PROFILE

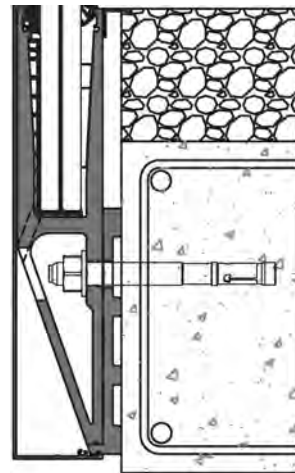
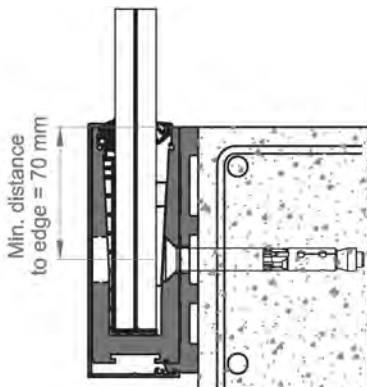

VIEW GLASS system fixed to wrought iron

Supply and collocation of the safety balustrade VIEW GLASS to wrought iron with a safety glass composed of a profile of aluminum alloy 6063 and thermal treatment T-6 reference 8553, including chocks and glazing joints according to the configuration of the glass, lateral cover caps and fixings to wrought iron.

Configuration of the laminated safety glass according to the maximum height from the inner side of the supporting profile to the upper side of the glass.

- 6 tempered / 4 PVB of 0.38 / 6 tempered for maximum height of 400 mm.
- 8 tempered / 4 PVB of 0.38 / 8 tempered for maximum height of 800 mm.
- 10 tempered / 4 PVB of 0.38 / 10 tempered for maximum height of 1,100 mm.

Categories achieved at test centre*:

Observance of the specifications of UNE 85-238-91 norm for the following tests:

1. Static horizontal test towards the exterior.
 - a. For private places in length parking areas <3.25 m.
2. For public places.
3. Static horizontal test towards the interior.
4. Dynamic test with mild object.
5. Dynamic test with hard object.

Observance of the requirements of the CTE DB SE-AE section 3.2 for the categories/subcategories of use where a resistance of de 0.8 kN/m is demanded.

- A. Residential areas.
- B. Administrative areas.
- C1. Areas with tables and chairs of public Access.
- C2. Areas with fixed chairs, of public Access.
- D. Commercial areas.
- G. Covers accessible only for conservation.

Observance of the specifications of the Eurocode 1, actions on structures (UNE-EN 1991-1-1:2003/AC:2010) indicated in table 6.12, for the categories of use where a resistance of $\leq 1,0$ kN/m is demanded:

- A. Areas of domestic and residential activities.
- B. Office areas.
- C1. Areas with tables, etc., where people can gather.
- C2. Areas with fixed chairs, where people can gather.
- C3. Areas without obstacle for the movement of people, where people can gather.
- C4. Areas where physical activities are possible, where people can gather.
- G. Industrial use.

Superficial finishing:

-Roughed brush anodized done in a complete circle which comprises the operations of scouring, washing, anodized rusting, coloring and sealing. The thickness and quality of the anodized layer is guaranteed by the EWAA-EURAS label with a minimum value class..... micras.

VIEW GLASS system fixed to the edge of the iron work

Supply and collocation of the safety balustrading VIEW GLASS to the edge of the iron work with safety glass composed of profiles of aluminum alloy 6063 and thermal treatment T-6 with ref. 8552 for lower support and 8551 for lateral cover, including chocks and glazing joints according to the configuration of the glass, lateral cover caps and fixings to wrought iron.

Configuration of the laminated safety glass according to the maximum height from the upper side of the supporting profile to the upper side of the glass.

- 6 tempered/ 4 PVB of 0,38 / 6 tempered for maximum height of 400 mm.
- 8 tempered / 4 PVB of 0,38 / 8 tempered for maximum height of 800 mm.
- 10 tempered/ 4 PVB of 0,38 / 10 tempered for maximum height of 1.100 mm.

Categories achieved at test centre *:

Observance of the specifications of the standard UNE 85-238-91 for the following tests:

6. Static horizontal test towards the exterior.
 - a. For private places in length parking areas <3,25 m.
 - b. For public places.
 7. Static horizontal test towards the interior.
 8. Dynamic test with mild object.
 9. Dynamic test with hard object.
-
- C. Observance of the requirements of the CTE DB SE-AE section 3.2 for the categories/subcategories of use where a resistance of $\geq 0,8$ kN/m is demanded.
 - D. Residential areas.
 - E. Administrative areas.
 - C1. Areas with tables and chairs, of public Access.
 - C2. Areas with fixed chairs, of public Access.
 - D. Commercial areas.
 - G. Covers accessible only for conservation.

Observance of the specifications of the Eurocode 1, actions on structures (UNE-EN 1991-1-1:2003/AC:201) indicated in table 6.12, for the categories of use where a resistance of $\leq 1,0$ kN/m is demanded:

- A. Areas of domestic and residential activities.
- B. Office areas.
- C1. Areas with tables, etc., where people can gather.
- C2. Areas with fixed chairs, where people can gather.
- C3. Areas without obstacle for the movement of people, where people can gather.
- C4. Areas where physical activities are possible, where people can gather.
- G. Industrial use.

Superficial finishing:

-Roughed brush anodized done in a complete circle which comprises the operations of scouring, washing, anodized rusting, colouring and sealing. The thickness and quality of the anodized layer is guaranteed by the EWAA-EURAS label with a minimum value class..... micras.

CRYSTAL RAILING

OPTIONS

Options: Over slab assembly, flush over slab assembly, edge slab assembly (leveled to the slab or the finishing layer).

GLAZING OPTIONS

This railing system allows 12 glazing options: double laminated glazing (10, 8 or 6 mm thickness) with up to four 0.38mm polyvinyl coatings:

10- 1.52 -10	8- 1.52 -8	6- 1.52 -6
10- 1.14 -10	8- 1.14 -8	6- 1.14 -6
10- 0.76 -10	8- 0.76 -8	6- 0.76 -6
10- 0.38 -10	8- 0.38 -8	6- 0.38 -6



CATEGORIES ACHIEVED AT TEST CENTRE

Tests according to UNE 85237:1991, UNE 85.238:1991 and UNE 85240:1990, requirements established in CTE (DB SU-1 y DB SE-AE) y requirements established in Eurocode 1 according to EN 1991-1-1:2003 /AC:2010

CLASIFICACION ACCORDING TO UNE 85240:1990: **Class A-EXCELLENT**

Reference test on railing made of extruded aluminium and glazing, fixed to edge slab with total dimensions 1,100mm (H) x 1,500mm (L) referred to floor level.

Reference test on railing made of extruded aluminium and glazing, fixed over the slab with total dimensions 1,100mm (H) x 1,500mm (L) referred to floor level.

VIEW CRYSTAL PLUS
Maximum load: **3,0kN/m**

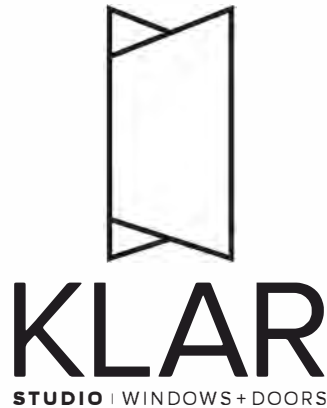

KLAR Studio was established with the sole mission to provide fully customizable, and energy efficient windows. We are a dedicated team of professionals located on the Gold Coast of Connecticut. Visit us and explore KLAR's unique combination of European innovation, efficiency, engineering and cutting-edge design. All of our windows, doors and accessory products are built with uncompromising precision and are fully guaranteed to last. Employing state-of-the-art production techniques and materials, including aluminum, steel, and wood, we offer an infinite amount of options, sizes, and glazing that are suitable for both modern and traditional applications.

Our customers range from homeowners, architects, designers, construction firms, developers and private institutions. We work with our clients individually to ensure the ultimate in quality, customer satisfaction and proper installation for all projects.

We invite you to discover KLAR Studio|windows+doors and how we can add value and transform your project.

